

PREPARED BY THE LA GRANGE CHAMBER OF COMMERCE, 1960

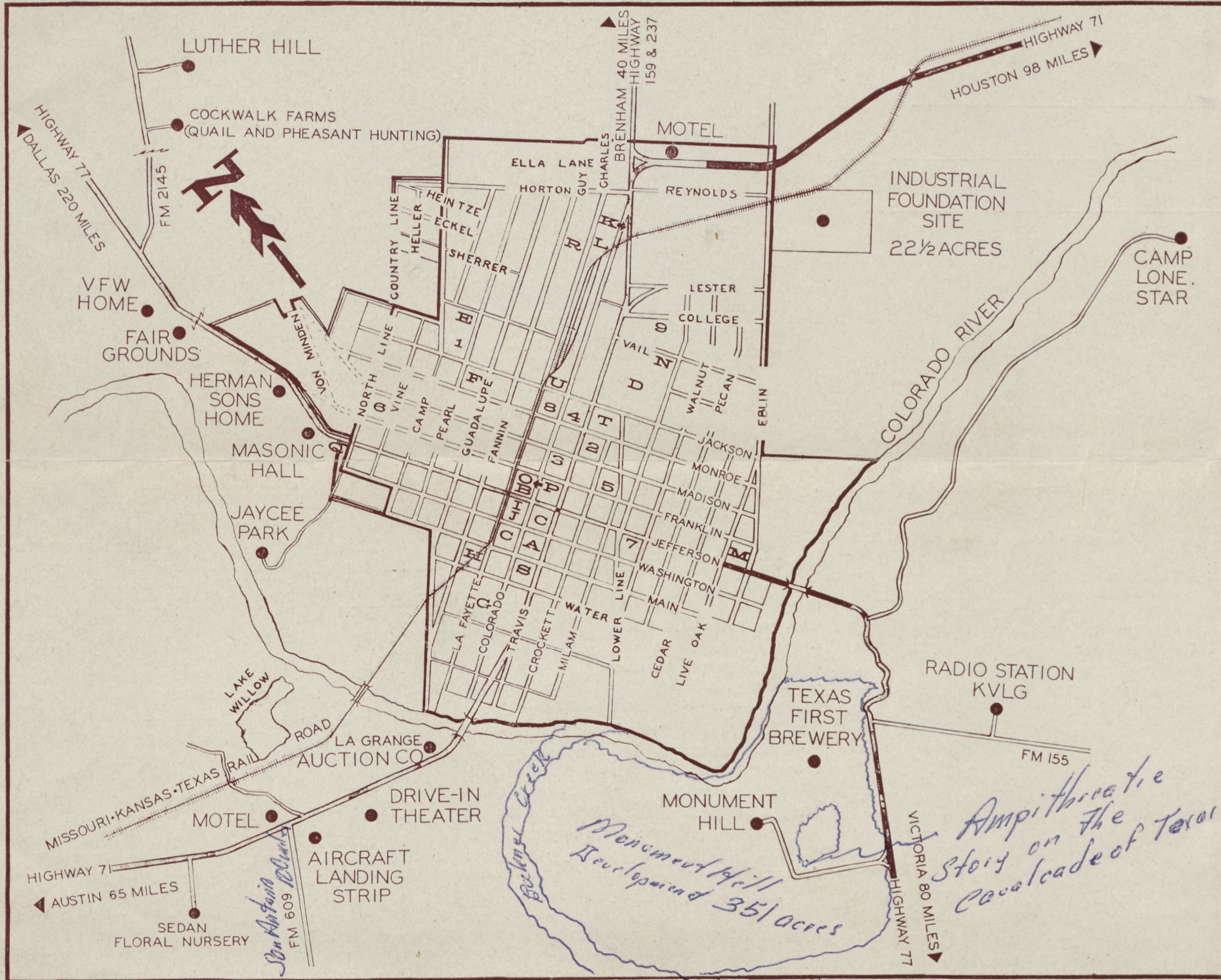

DESIGN

- A Fayette County Court House
- B U. S. Post Office
- C Banks
- D Public School (White)
- E Public School (Colored)
- F Fayette Memorial Hospital
- G La Grange Recreational Association Grounds (Swimming Pool - Little League Ball Park)
- H American Legion Hall (Bowling Alleys)
- I Hotel
- J Theatre
- K Consolidated Frozen Food Lockers
- L Farmers Grain Warehouse
- M City Park - Teenville and Boy Scout Hut
- N Girl Scout "Little House"
- O Agriculture Building
- P City Hall and Fire Station
- Q City Reservoir - Tower and Settling Tank
- R Cotton Compress
- S Bus Depot
- T South Texas Producers Association Plant
- U City Utilities Ice Plant

CHURCHES

- 1 Catholic
- 2 Methodist
- 3 Baptist
- 4 Episcopal
- 5 Presbyterian
- 6 Zion Lutheran
- 7 St. Paul's Lutheran
- 8 Church Of Christ
- 9 Assembly Of God

LA GRANGE TEXAS

welcome to **LA GRANGE**
texas



LA GRANGE...

The business center of a progressive agricultural community, has the essentials that are making it increasingly a center of industry—natural gas, low cost electric power, ample labor, excellent transportation by rail, truck and bus and a network of good highways, a city council form of government and low tax renditions.

LA GRANGE NOW HAS:

A milk plant serving dairy farmers from more than 60 counties, handling milk valued at over two million dollars annually;

A grain warehouse, processing and storing grain for farmers of Fayette and adjoining counties;

A cotton compress, compressing and storing cotton for many Texas counties;

A cotton warehouse, storing cotton in approved warehouse from throughout the State;

A steel fabricating plant and machine works—outstanding in equipment and technical skill;

An up-to-date interior decorating establishment excelling in custom made draperies;

A wholesale nursery, distributing flowers and shrubs through the Southwest;

A government approved livestock auction company—marketing thousands of head of head of cattle, sheep, goats and hogs annually;

Distribution center for 6 major oil and gasoline companies;

Two cotton gins;

Seven feed mills;

A wholesale tire establishment;

A wholesale auto parts company;

Five nationally known farm equipment distributors;

Two florists;

A granite works;

Three washaterias or laundromats;

Automobile dealers offering 15 leading makes of automobiles;

Prefabricated cedar fence company,
Custom furniture manufacturing;

A host of construction contractors;

A medical center for a large area, providing modern hospital facilities by a non-profit corporation;

A bakery;

Four medical clinics; optometrists; dentists; a chiropractor and rest homes for the aged;

The homes of an insurance company and a large fraternal order; district and local offices for nine insurance companies;

A soft drinks bottling plant, and two soft drinks distributors;

Five wholesale beer distributors;

Two locker plants;

Three hatcheries;

Two banks;

Two newspapers;

Two modern motels and a hotel;

Eight first class cafes;

A mattress factory;

Radio Station KVLG;

A large sand and gravel shipping establishment;

Two Farm Credit lending institutions;

An abstract company and two title guaranty companies;

A photographic studio;

Two furniture upholstery establishments;

More than a hundred retail businesses.

An Industrial Foundation offering assistance to industry establishing in this trade area.

A concrete mixing plant.

A most healthful climate; elevation 275 feet; annual mean temperature of 63°; an average rainfall of 36½ inches, and approximately 4,000 population.

Its own electric distribution system with low rates. An ample supply of good water from city-owned wells; also a modern ice plant.

Natural gas is supplied by the United Gas Corporation.

Telephone service is supplied by the Southwestern States Telephone Company.

La Grange has a modern swimming pool and Little League lighted ball park; a city park; and one of the most beautiful parks in the State on Monument Hill overlooking the city of La Grange on a high bluff on the Colorado River, visited by many thousands annually; nine churches and four Colored churches; two picture shows; city library; tennis courts; bowling alleys; lighted baseball field; Legion Hall; VFW Home; Boy Scout Hut; Girl Scout "Little House;" Hermann Sons Hall; Masonic Lodge Hall; Teenville building; MKT railroad depot; Kerrville Bus depot; Luther Hill and Camp Lone Star—state camps for the United Lutheran and Missouri Synod churches.

The public schools are rated among the State's best. Two elementary parochial schools also have modern plants and ample playgrounds.

The city tax rate is \$1.30 per hundred dollars rendition. The school tax rate is \$1.20 per hundred. The county bonded indebtedness is low and the tax rate on the hundred dollars is 80 cents which includes a 30 cent lateral road tax.

Agricultural activities are highly diversified; principal crops are cotton, grain sorghum, corn, oats, peanuts and pecans for market. Diversification includes livestock, beef cattle, dairy cattle, sheep, goats, hogs, poultry and honey. Fayette County has 3700 farms and ranches. 92% of them have electricity. Nearby oil field, charcoal and bentonite is in production. Large quantities of bentonite, fullers earth, clays and lignite are still undeveloped. Pine, cedar, oak and other timber are available for processing.

The Industrial Foundation owns and has available for industry a plot containing considerable acreage near a highway adjoining MKT railroad with all utilities accessible. It adjoins the southeast city limits of La Grange.

LA GRANGE INVITES INDUSTRY!

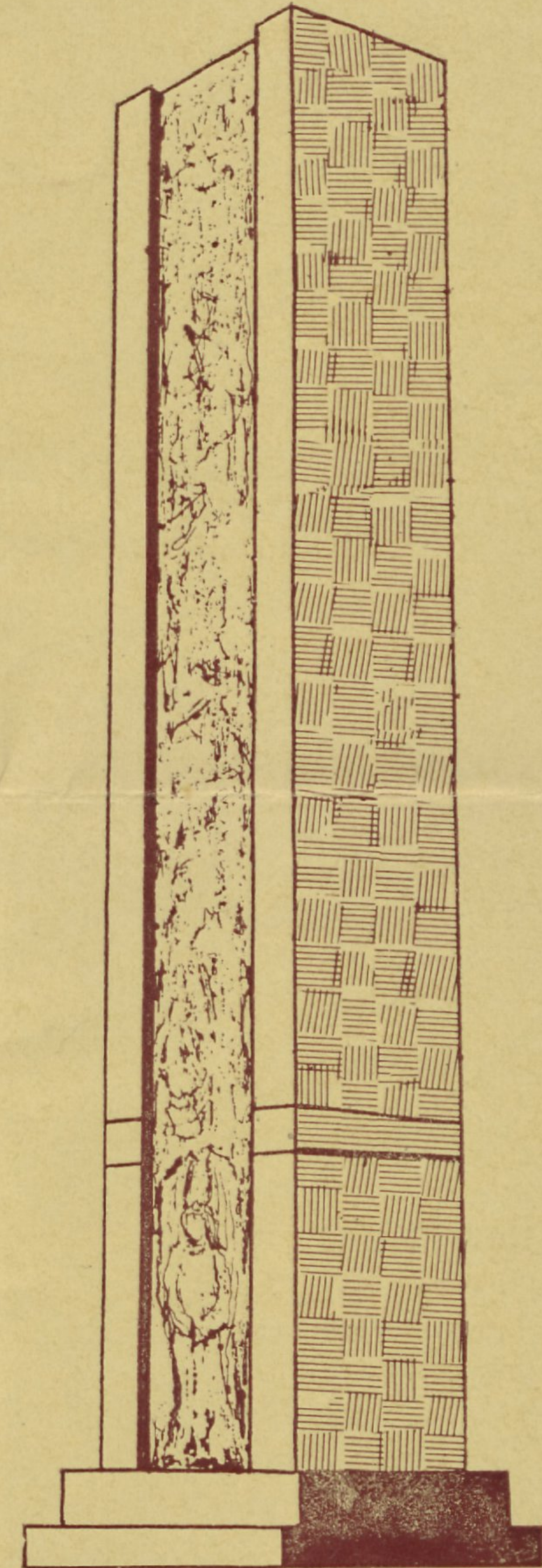

A MAJESTIC MEMORIAL OVERLOOKS THE CITY

LA GRANGE, TEXAS

A CITY OF GOOD NEIGHBORS

CHAMBER OF COMMERCE
LA GRANGE, TEXAS