

Saint Paul's Episcopal Church  
Edenton, North Carolina  
Founded 1701

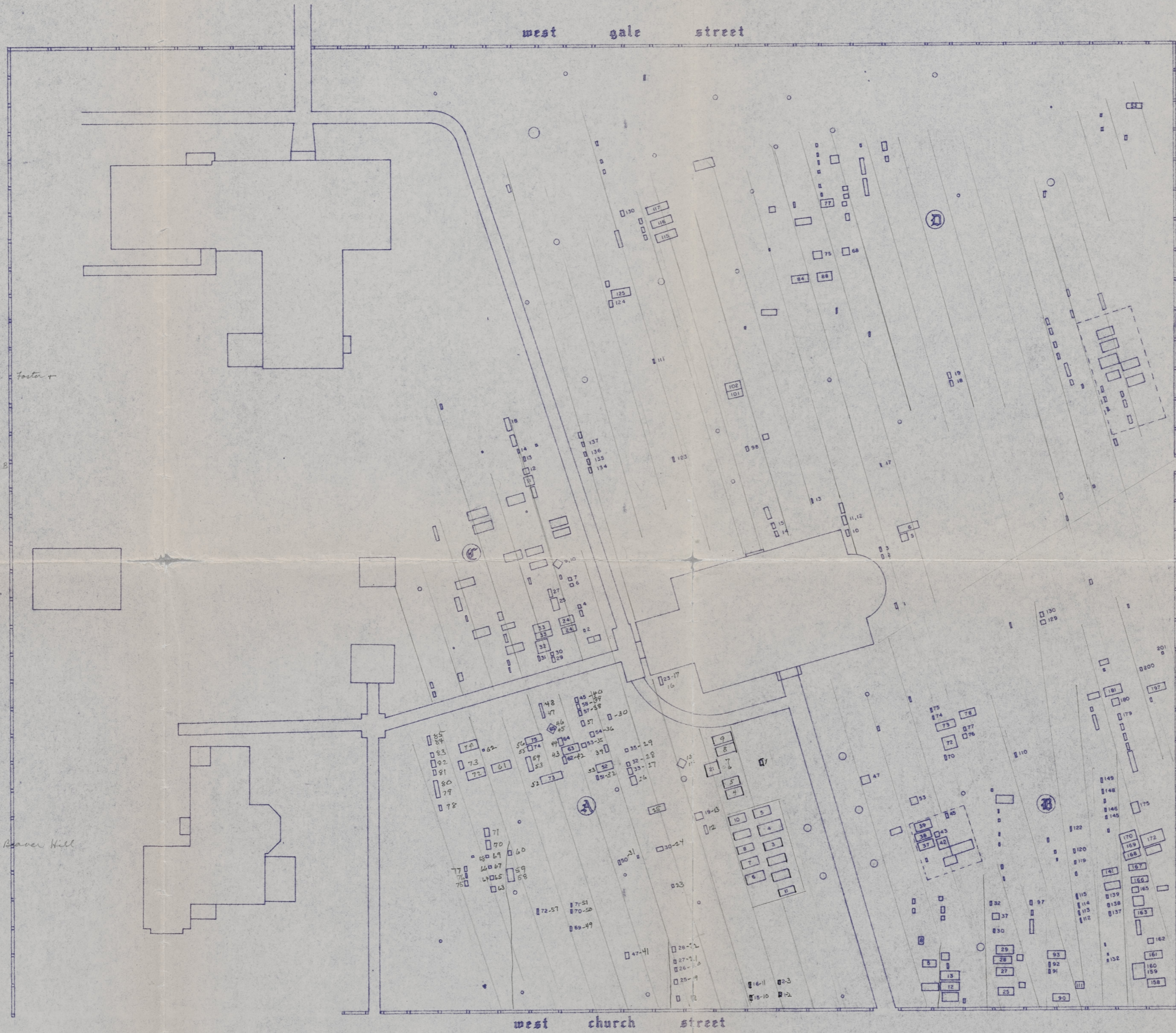

- 1 SARAH HEARDON 1836
- 2 THOMAS W. MOORE 1837
- 3 HARRIET W. MOORE 1837
- 4 ELIZABETH WOODS SUMNER 1837
- 5 CHARLES SKINNER 1837
- 6 JOHN A. MOORE JR 1838
- 7 JOHN A. MOORE 1838
- 8 HENRY A. MOORE 1838
- 9 RICHARD DILLARD 1837
- 10 MARY D. DILLARD 1838
- 11 MARY D. DILLARD 1838
- 12 DUNCAN DIXON 1838
- 13 PENELope DIXON 1838
- 14 SARAH DIXON 1838
- 15 SARAH DIXON 1838
- 16 SARAH DIXON 1838
- 17 SARAH DIXON 1838
- 18 SARAH DIXON 1838
- 19 SARAH DIXON 1838
- 20 SARAH DIXON 1838
- 21 SARAH DIXON 1838
- 22 SARAH DIXON 1838
- 23 SARAH DIXON 1838
- 24 SARAH DIXON 1838
- 25 SARAH DIXON 1838
- 26 SARAH DIXON 1838
- 27 SARAH DIXON 1838
- 28 SARAH DIXON 1838
- 29 SARAH DIXON 1838
- 30 SARAH DIXON 1838
- 31 SARAH DIXON 1838
- 32 SARAH DIXON 1838
- 33 SARAH DIXON 1838
- 34 SARAH DIXON 1838
- 35 SARAH DIXON 1838

- 1 THOMAS DENHOOD 1771
- 2 ELIZABETH YOUNG 1805
- 3 WILLIAM McDONALD 1795
- 4 MARY McD DIXON 1849
- 5 COUSANDE DIXON 1855
- 6 SALLIE SUMMERELL 1881
- 7 THOMAS SUMMERELL 1881
- 8 ELIZABETH SUMMERELL 1884
- 9 MARY WALKER 1881
- 10 MARY WALKER 1902
- 11 HELEN NILES 1908
- 12 EMMA LEWIS 1845
- 13 ANNA DARRIN 1856
- 14 SARAH WARRER 1812
- 15 THOMAS WARRER 1878
- 16 BETTIE W. MOORE 1878
- 17 WARDABET WARRER 1854
- 18 JAMES C. FIELD 1853
- 19 SARAH KNOX 1833
- 20 SALLIE B. WARRER 1881
- 21 HENRY W. WARRER 1902
- 22 WILLIAM WARRER 1884
- 23 FRANCES WARRER 1884
- 24 MARGARET BOND 1910
- 25 JESSE BOND 1893
- 26 SARAH BOND 1893
- 27 SARAH BOND 1893
- 28 SARAH BOND 1893
- 29 SARAH BOND 1893
- 30 SARAH BOND 1893
- 31 SARAH BOND 1893
- 32 SARAH BOND 1893
- 33 SARAH BOND 1893
- 34 SARAH BOND 1893
- 35 SARAH BOND 1893
- 36 SARAH BOND 1893
- 37 SARAH BOND 1893
- 38 SARAH BOND 1893
- 39 SARAH BOND 1893
- 40 SARAH BOND 1893
- 41 SARAH BOND 1893
- 42 SARAH BOND 1893
- 43 SARAH BOND 1893
- 44 SARAH BOND 1893
- 45 SARAH BOND 1893
- 46 SARAH BOND 1893
- 47 SARAH BOND 1893
- 48 SARAH BOND 1893
- 49 SARAH BOND 1893
- 50 SARAH BOND 1893

- 1 CLARA COTTEN 1848
- 2 JAMES COTTEN 1852
- 3 STEPHEN CABARRUS 1808
- 4 LOUISA PATTON 1866
- 5 HENRIETTA CABARRUS 1799
- 6 CLORIE LILLINGTON 1756
- 7 ANNE MOSELEY 1732
- 8 HENRIETTA WARRER 1708
- 9 SARAH SWEETMAN 1745
- 10 THOMAS POLLOCK 1723
- 11 CHARLES EDDY 1725
- 12 SARAH POLLOCK 1728
- 13 THOMAS POLLOCK 1728
- 14 MARY POLLOCK 1728
- 15 HENRY BOND 1817
- 16 ELIZA BOND 1826
- 17 WALTER LEARY 1897
- 18 MARY LEARY 1897
- 19 MICHAEL LEARY 1897
- 20 THOMAS H. LEARY 1891
- 21 MARTIN P. LEARY 1894
- 22 JAMES CHESTER 1873
- 23 JOHN H. CHESTER 1886
- 24 MARY ANNE MC CUNEY 1903
- 25 ELIZABETH WARRER 1847
- 26 MARY BRIGHT 1862
- 27 MARTHA BRIGHT 1877
- 28 MARY BRIGHT 1882
- 29 MARY BRIGHT 1882
- 30 MARY BRIGHT 1882
- 31 MARY BRIGHT 1882
- 32 MARY BRIGHT 1882
- 33 MARY BRIGHT 1882
- 34 MARY BRIGHT 1882
- 35 MARY BRIGHT 1882
- 36 MARY BRIGHT 1882
- 37 MARY BRIGHT 1882
- 38 MARY BRIGHT 1882
- 39 MARY BRIGHT 1882
- 40 MARY BRIGHT 1882
- 41 MARY BRIGHT 1882
- 42 MARY BRIGHT 1882
- 43 MARY BRIGHT 1882
- 44 MARY BRIGHT 1882
- 45 MARY BRIGHT 1882
- 46 MARY BRIGHT 1882
- 47 MARY BRIGHT 1882
- 48 MARY BRIGHT 1882
- 49 MARY BRIGHT 1882
- 50 MARY BRIGHT 1882

- 1 MARYAN CHRISTIAN 1817
- 2 RICHARD PATTON 1824
- 3 ELIZABETH SIMMER 1820
- 4 LOUISA PATTON 1866
- 5 RICHARD PATTON 1822
- 6 LAVINIA PATTON 1824
- 7 JOHN A. BERRY 1862
- 8 WILLIAM C. PATTON 1883
- 9 THOMAS BERRY 1867
- 10 ELIZABETH BERRY 1862
- 11 LOUIS BERRY 1864
- 12 MARY BERRY 1870
- 13 ANNIE PATTON 1864
- 14 ELIZABETH WARRER 1880
- 15 ELIZABETH BERRY 1870
- 16 THOMAS C. BERRY 1862
- 17 LEAH BERRY 1878
- 18 MICHAEL WOOD 1848
- 19 FRANCIS WOOD 1849
- 20 BENJAMIN WOOD 1838
- 21 JOHN WOOD 1838
- 22 ELIZABETH WARRER 1847
- 23 SARAH WARRER 1847
- 24 FANNIE WARRER 1847
- 25 WILLIAM A. MOORE 1884
- 26 FANNIE MOORE 1869
- 27 JOHN ALFRED MOORE 1834
- 28 PATRICK WARRER 1822
- 29 SUSAN WARRER 1837
- 30 ALFRED MOORE 1824
- 31 SUSAN MOORE 1854
- 32 AUGUSTUS MOORE 1851
- 33 SARAH MOORE 1841
- 34 SUSAN WARRER 1866
- 35 MARY WARRER 1833
- 36 MARY WARRER 1833
- 37 MARY WARRER 1833
- 38 MARY WARRER 1833
- 39 MARY WARRER 1833
- 40 MARY WARRER 1833
- 41 MARY WARRER 1833
- 42 MARY WARRER 1833
- 43 MARY WARRER 1833
- 44 MARY WARRER 1833
- 45 MARY WARRER 1833
- 46 MARY WARRER 1833
- 47 MARY WARRER 1833
- 48 MARY WARRER 1833
- 49 MARY WARRER 1833
- 50 MARY WARRER 1833

Outside the entry for 34 Peninsula  
fourth is cancelled, also  
type letter

myc. foster

o Sophia Mitchell 1877

also George Blair 1810

1788

1809

1814

1815

1819

1824

1827