

Scale 100 ft The Inch

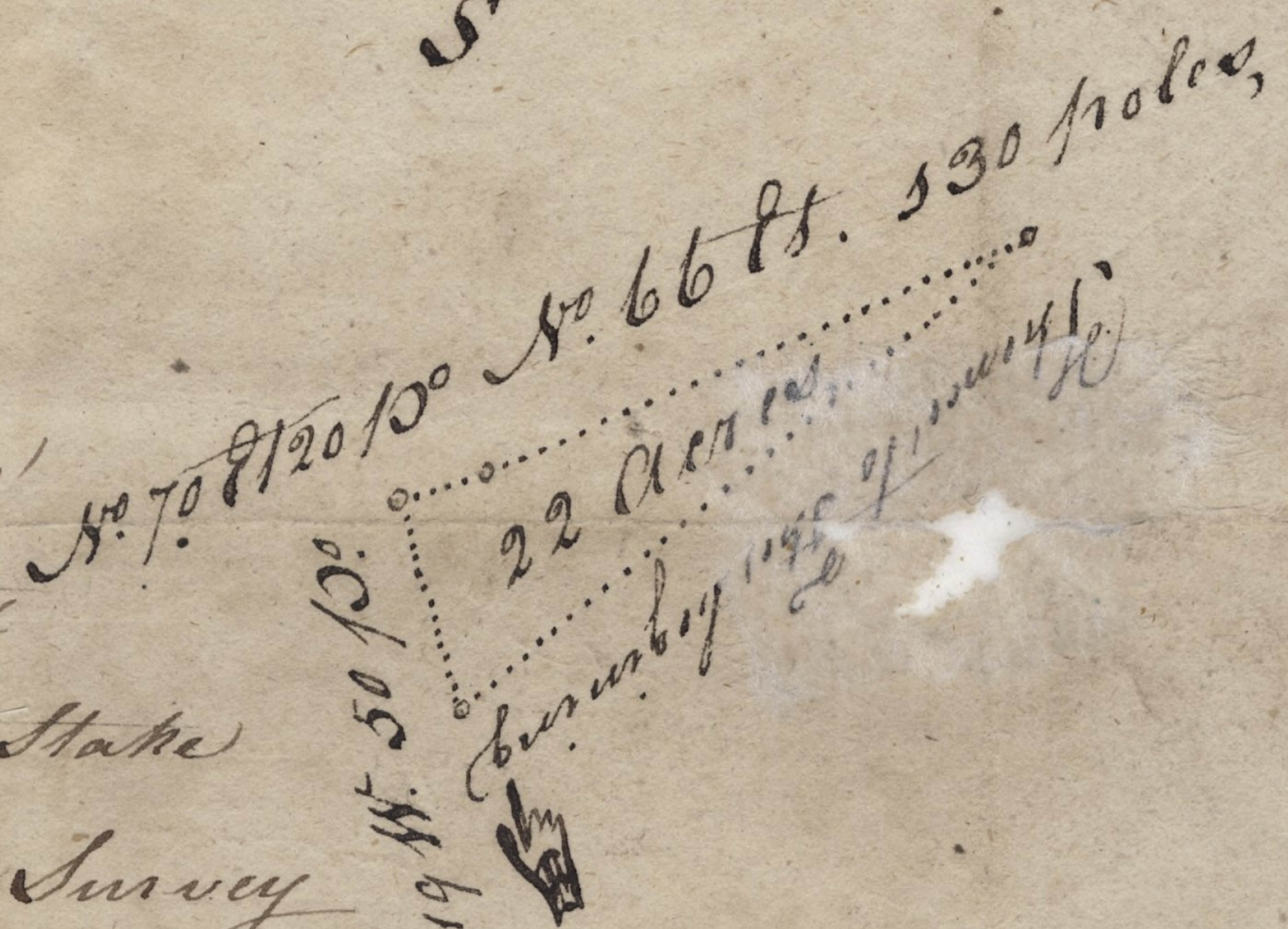

Carteret } N^o 1410 Survey for
County } William Borden
Two acres of Land Beginning at Stake
in Borden's Line. Being an Old Survey



Bought of William Borden and at Samuel Green's Corner
running up said Borden's Line N^o nineteen degrees West fifty
poles to William Morine's Corner in said Line Thence N^o seventy
Eight Twenty poles Thence N^o sixty six East One hundred &
Thirty poles to said Borden's Back Line of the Land he
Bought of Samuel Green Thence to the first Station

Survey June 9th 1701

By W^m Taylor Surveyor