

HYNDMAN'S CRIMPED SIDING OR CEILING.

Sheets Well Painted Both Sides.

Standard Roofing Gauge Weight, - - - - - 75 Pounds to the Square.
Shipping Weight, - - - - - 80 to 85 Pounds.

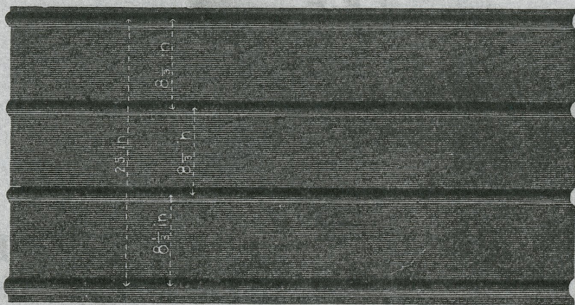

Sheets Cover 25 Inches in Width.

Sheets 6, 7 and 8 Feet Long.

A SQUARE—Consists of six eight-foot sheets, or 48 feet of 6 and 7 foot sheets.

PRICE LIST—\$3.75 per Square; Paint and Nails Extra.

NET PRICE

These sheets are far *preferable* for siding to any Corrugated Iron; they can be applied either horizontally or perpendicularly, with much less expense than Corrugated. *A Square covers from four to five per cent. more surface than Corrugated Iron.*

These sheets make a neat, plain ceiling at a small cost.

W. G. HYNDMAN & CO., Manufacturers of IRON & STEEL ROOFING, 52 & 54 East Second Street.

Cincinnati, O., September 1, 1890.

Dear Sirs:

On other side of this sheet find description of our new CRIMPED SIDING and CEILING which we are just putting on the market; it possesses so many advantages over Corrugated Iron for both siding and ceiling that it will in a measure supersede same.

First: A square of this siding will cover from four to five per cent. more surface than a square of Corrugated as usually sold while the price is the same.

Second: This siding is more easily cut to necessary lengths than Corrugated, and the ends are more easily made to fit neatly together; therefore the cost of putting it on is less than for Corrugated.

Third: This siding can be laid horizontally or perpendicularly equally well, and will make an excellent appearance in either case.

Fourth: This crimped siding makes the best and cheapest, and most easily applied of any ceiling ever put on the market.

We would be pleased to have you give this material a trial knowing that it will be in every way satisfactory.

Yours truly

W. G. HYNDMAN & CO.

SEND THIS WITH YOUR ORDER.

W. G. HYNDMAN & CO.,
—MANUFACTURERS OF—
IRON AND STEEL ROOFING,
CORRUGATED AND CRIMPED.

52 & 54 East Second Street, CINCINNATI, O.

FIG. 1—FOR RIDGE ROOF.

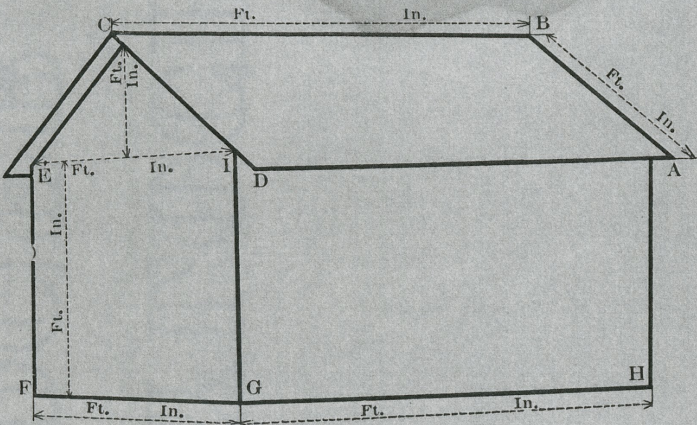
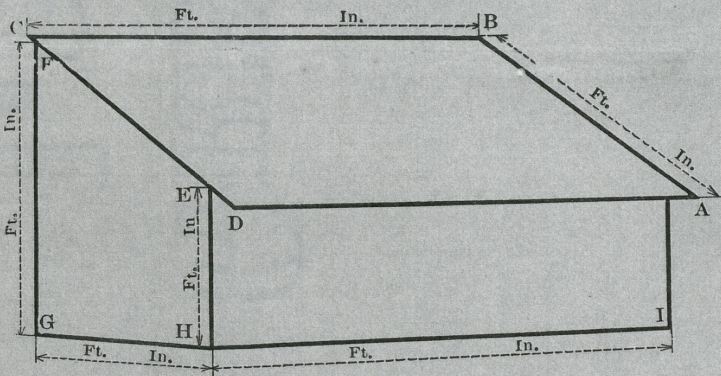

FIG. 2—FOR SHED ROOF.



FOR ROOFING--Fill out Blanks left for Measurements of Roof.
FOR SIDING--Fill out Blanks left for Measurements of Sides.

☞ If you do not want the Siding do NOT fill out the measurements indicated for Sides.